



USER MANUAL

**EV CHARGER TYPE 2
2IN1 3.5kW 230V**

**EV CHARGER TYPE 2
2IN1 7kW CEE 5 PIN**

**EV CHARGER TYPE 2
2IN1 11kW CEE 5 PIN**

Model: 52470, 52471, 52475, 52476, 52477, 52478

CONTENTS

Safety information.....	2
Specifications.....	4
Product descriptions.....	4
Information for use.....	6
How to start charging.....	8
How to stop charging.....	9
Charge current setting.....	10
Charge delay setting.....	11
Charging instructions with application.....	12
WiFi/Wireless configuration.....	13
Application download.....	14
APP Function.....	15
LCD display.....	17
Troubleshooting.....	18

SAFETY INFORMATION

Thank you for your trust and for purchasing our product. We have made every effort and are confident that the product will meet your expectations.

This manual contains important information on safety and operation of the unit. If you have any questions after reading this manual, please contact Ntec sp. z o.o. Customer Service.



CAUTION

- Protect from rain - use in a roofed area.
- Do not immerse the control module in water.
- Do not trample, pull, bend or tie the cable.
- Do not drop the control module or place heavy objects on it.
- Do not place the device near sources of high temperature during charging.
- Do not place the device in a car or in an enclosed space while charging.
- Do not use the device at temperatures exceeding its operating range of -30°C to $+50^{\circ}\text{C}$.

SAFETY INFORMATION



WARNING

- Only for use when the mains supply is equipped with a residual current circuit breaker.
- Do not attempt to repair the device yourself in case of a fault.
- Do not use the unit if the cable is damaged.
- The device is designed for charging electric vehicles only.
- Do not use the device with an additional extension cord.
- Do not insert fingers into the charging connector.
- If the unit does not work, contact your dealer for repair or replacement.

SPECIFICATIONS

	MODEL : 52470, 52476	MODEL : 52471 52477	MODEL : 52475 52478
STANDARDS	EC62196-2		
VOLTAGE	230V		
CURRENT	16/13/10/8A	32/24/20/16A	16/13/10/8A
FREQUENCY	50Hz		
POWER	3.5kW	7kW	11kW
OPERATING TEMPERATURE	-30°C ~ +50°C		
OPERATING HUMIDITY	5% to 95% RH, non-condensing		
PROTECTION CLASS	Control module: IP65 Charging connector: IP65		
DIMENSION	40cm*34.5cm*14cm		
INSULATION RESISTANCE	>10MΩ		
SCREEN SIZE AND DISPLAY TYPE	LCD 2,4"		

PRODUCT DESCRIPTION

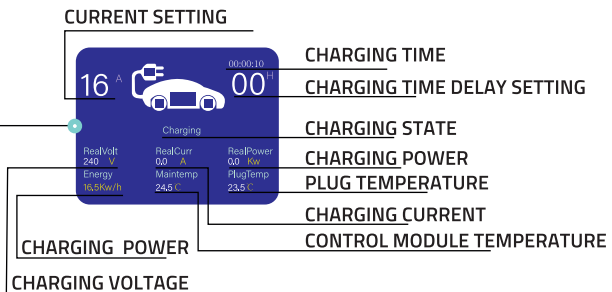

CHARGER STATUS INDICATOR	CHARGER STATUS
BLUE LIGHT	STAND BY
GREEN LIGHT	CHARGING COMPLETED
COLORFUL LIGHT	CHARGING/CONNECTED
YELLOW LIGHT	DELAY CHARGING
RED LIGHT	FAULT

- Temperature Monitoring
This function monitors the operating temperature of the charger in real-time. If it exceeds a safe temperature, the charger will stop operation immediately. Once the temperature returns to normal levels, the charger will automatically resume operation.
- Automatic fault correction
An intelligent chip automatically corrects common charging faults to ensure stable product operation.
- Safety
The product has undergone proper inspection to ensure the highest safety standards during charging for you and your car.
- Durable casing
Made of polycarbonate, the casing is strong and reliable, an internal endurance test showed no damage with a momentary weight of 1.5t.

PRODUCT DESCRIPTION

MODEL: 52470, 52476

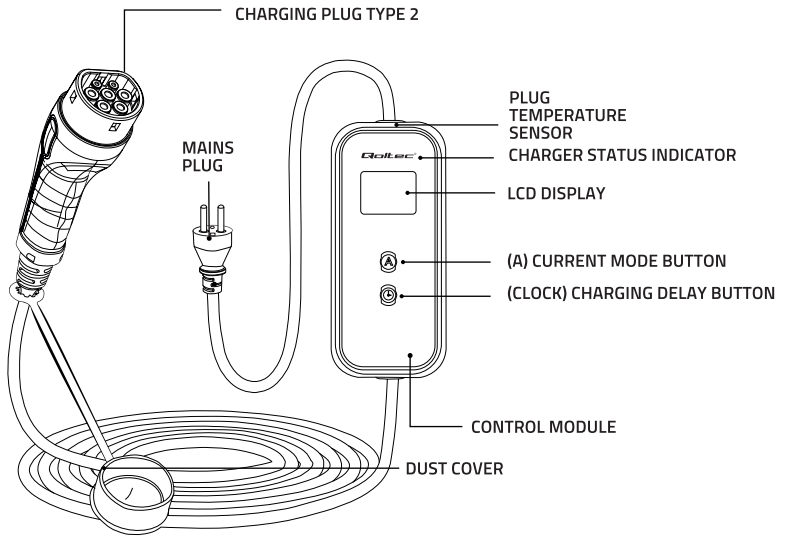

MODEL: 52471, 52475, 52477, 52478

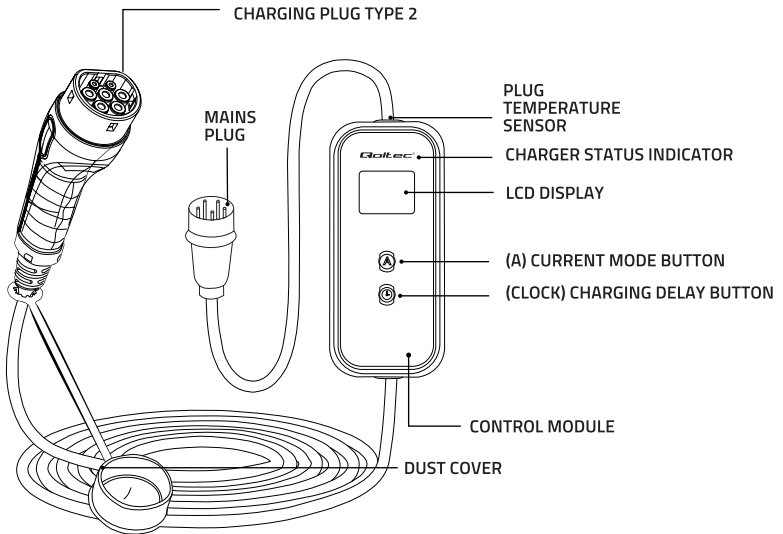

INFORMATION FOR USE

1. When using the charger, ensure that the current mode is correctly matched to the current of the mains socket and does not exceed its maximum values. If the charger is damaged due to the current mode being incorrectly matched to the mains socket, you will not be able to make use of the warranty.
2. Do not place flammable materials, explosives, chemicals or other hazardous substances near the device.
3. Keep the charging connector clean, if it is dirty, wipe it with a clean dry cloth, do not touch the metal pins in the connector with your hand. Make sure the charger is not connected to the mains or the device.
4. Do not use the charger if the cable is damaged, cracked, worn or has exposed core. If you notice the above abnormalities, contact your dealer.
5. Do not attempt to disassemble, repair or upgrade the charger yourself. Improper handling may result in damage to the equipment, loss of integrity, current leakage, etc.
6. In the event of any abnormality during use, cut the power off immediately.

USE PRECAUTIONS

7. Use the charger under the roof during precipitation. Protect the charger from rain and snow.

8. Children are not allowed to use or access the device during the charging process due to the possible risk of injury.

9. It is strictly forbidden to remove the charging plug from the socket without authorisation during the charging process, due to the risk to vehicle or user safety.

10. Vehicles cannot move during charging. Charging may only be carried out when the vehicle is stationary. This applies to all vehicle types.

HOW TO START CHARGING

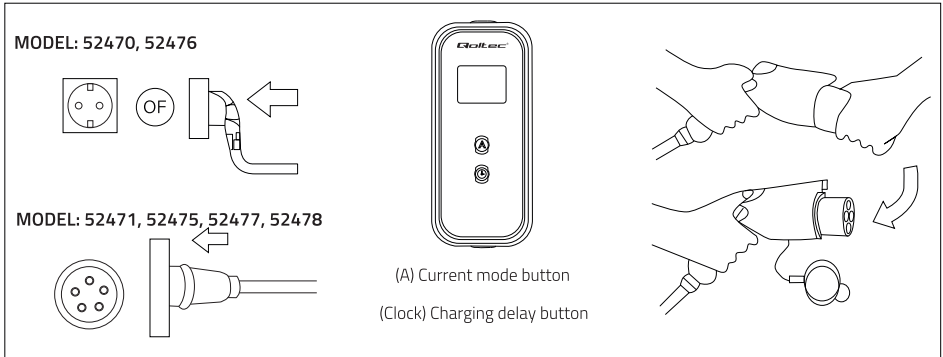

Figure 1

Figure 2

Figure 3

1. Firmly insert the plug into the mains socket (fig. 1).



Make sure that the mains socket complies with the national standard and that the current rating of the socket is 16A for the 2470, 52476, 52475, 52478 and 32A for model 52471, 52477.

2. Press the [A] button to switch the charging current mode, press the [CLOCK] button to schedule the charging time delay (fig. 2).

3. Pull the cap slightly and fully insert the charging connector into the socket (fig. 3).



Make sure the charging connector is fully inserted (until you hear a click).

4. The device will start charging.

HOW TO STOP CHARGING

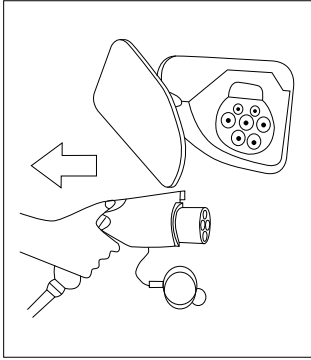

Figure 4

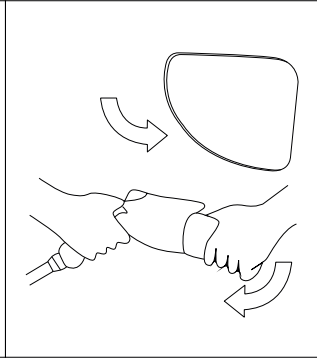

Figure 5

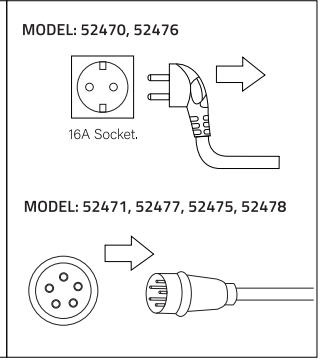

Figure 6

1. Press the button and disconnect the charging connector (fig. 4).
2. Close the car socket cover and put the protective cap on the charging connector (fig. 5).
3. Disconnect the plug from the mains socket (fig. 6).
4. Put the charger in its bag.

* Some cars lock the charging connector when the power is on (turn the power off before removing the charging connector).

CHARGE CURRENT SETTING

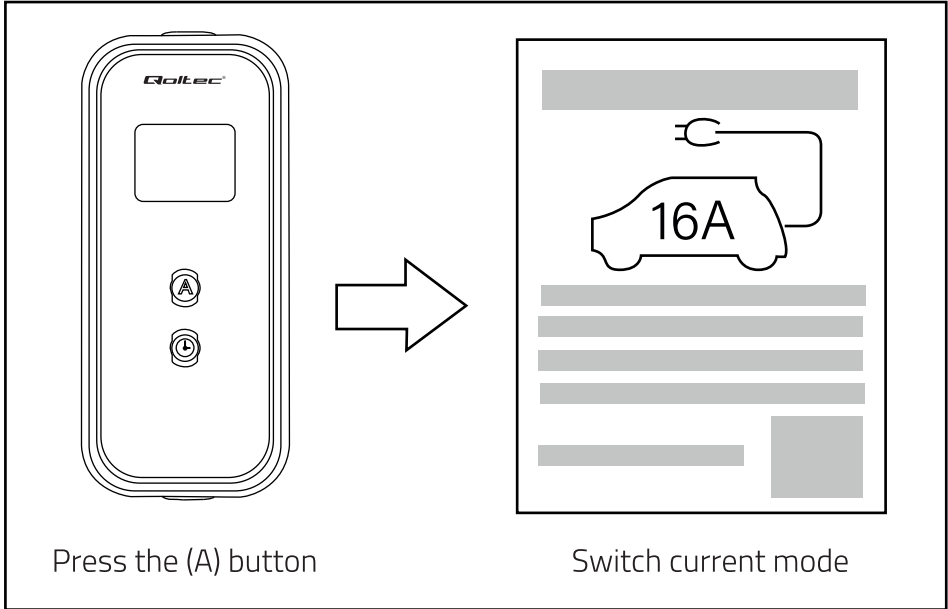

Figure 7

1. The mode can be activated by pressing the [A] button when the charger is powered on and no car is connected to it.
2. The 16A device (model: 52470, 52476, 52475, 52478) supports four current modes: 8A, 10A, 13A and 16A.
3. The 32A device (model: 52471, 52477) supports four current modes: 16A, 20A, 24A and 32A.

CHARGE DELAY SETTING

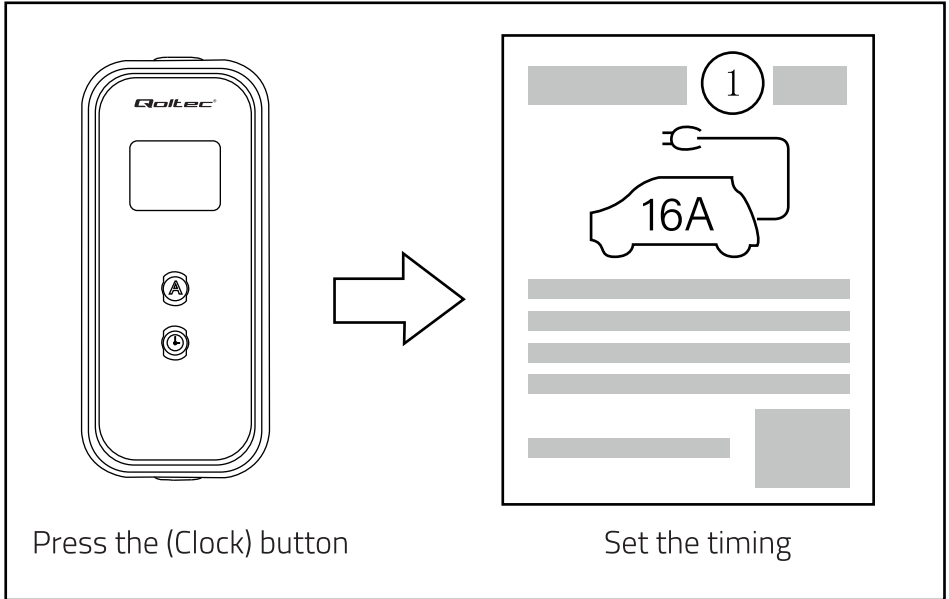
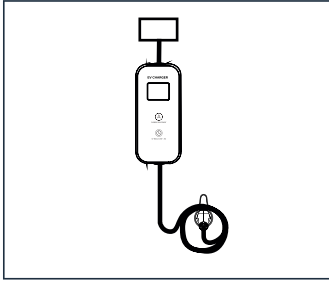

Figure 8

1. The mode can be activated by pressing the [Clock] button when the charger is powered on and no car is connected to it.
2. The charging delay time increases by 1 hour when the [Clock] button is pressed once. The maximum delay is 8 hours.

CHARGING INSTRUCTIONS

MODEL: 52476, 52477, 52478



1. Make sure the charging pile is properly connected to the power supply.

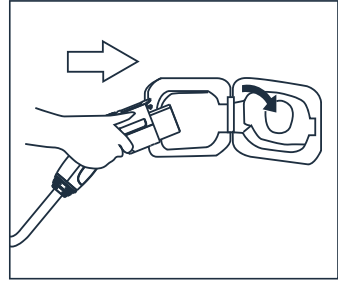

2. Put the charging plug Connect the on-board charging interface.

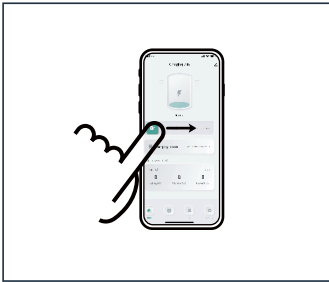

3. Use swipe APP to start.

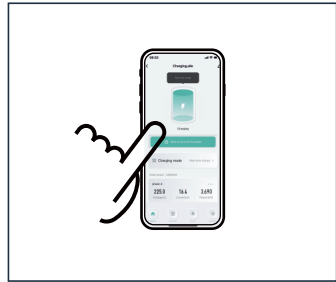

4. Click the APP to end

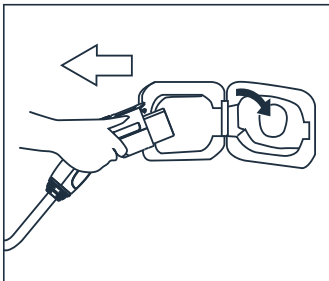

5. Unplug the charging plug.

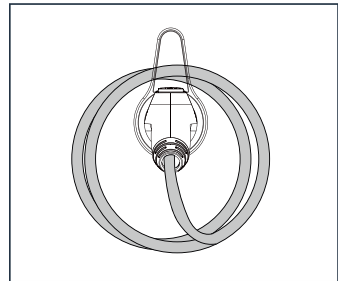

6. Unplug the charging plug put it back.

WIFI/WIRELESS CONFIGURATION

MODEL: 52476, 52477, 52478

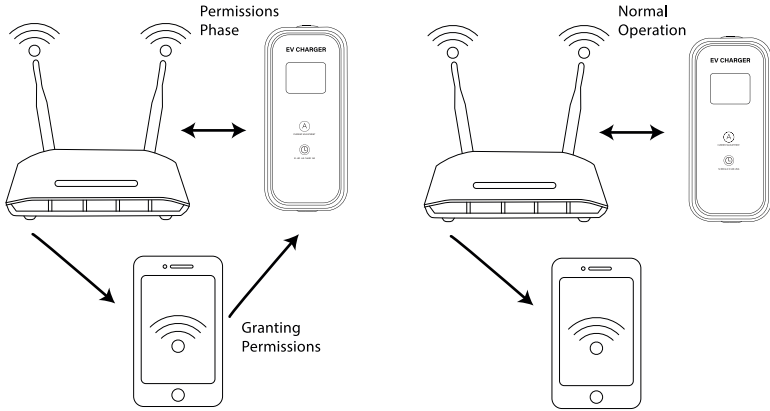

The EV Charger (WIFI Model) supports wireless charge monitoring and control. Wireless charge monitoring and control requires the user to have an accessible local router (2.4G) as well as a smartphone capable of operating the Tuya application (APP).

WIFI QUICKSTART GUIDE

1. Download Tuya Application either from Google or Iphone Appstore.



2.Plug in the EV Charger - Note the charger only searches for connectivity within the first 30 seconds of turning on.

APPLICATION DOWNLOAD

MODEL: 52476, 52477, 52478

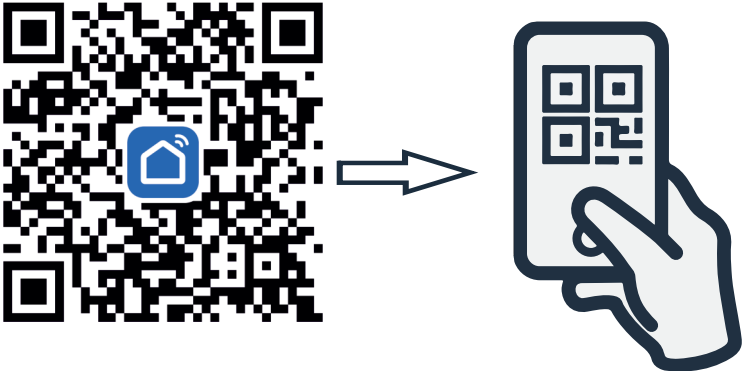

1. Scan the QR code to the app store for download the APP: Smart Life

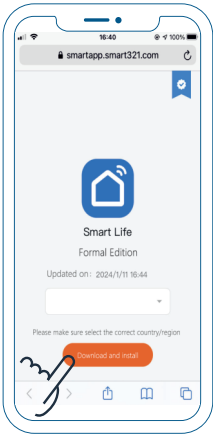

2. Click from the link.



3. Click to download and install.

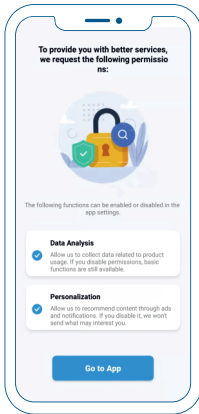

1. Enter the APP.
Click to enter APP.

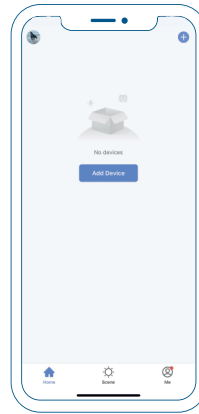

2. Add equipment.
Top right corner + open point.
Select Add device.

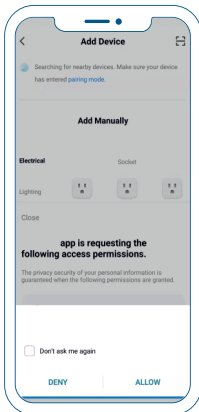

3. Access permissions.
Need to allow app access to mobile phone.

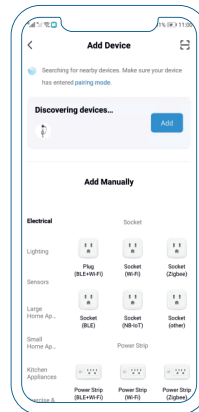

4. Search equipment.
The first connection to the device requires the mobile phone and the device to match under the same WiFi condition.

APP FUNCTION

MODEL: 52476, 52477, 52478

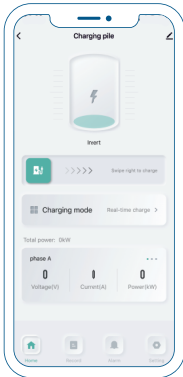

Charging

Slide right to the bottom and switch on charging.

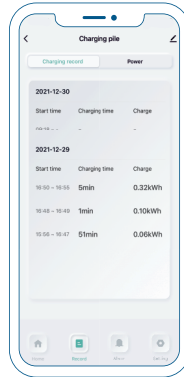

Record of charging.

View historical charging records

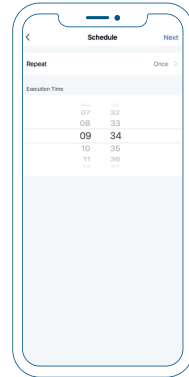

Adjust the time.

Selecting an appointment time.

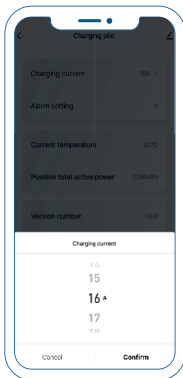

Adjust current.

Slide up and down to set charging current.

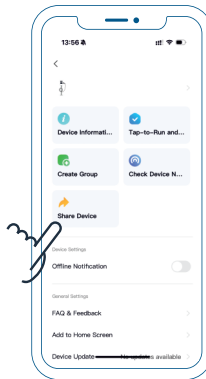

Share the APP.

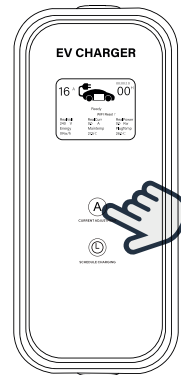

Move the APP user.

Press and hold the A current button for 10-15 seconds. Once the screen shows the Wifi reset, then press the Alarm button.

INTRODUCTION OF SCREEN DISPLAY

1. Loading



2. Unconnected

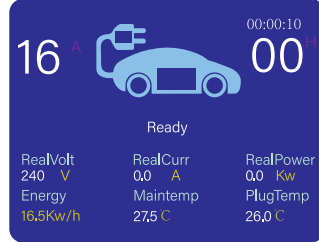

3. Charging

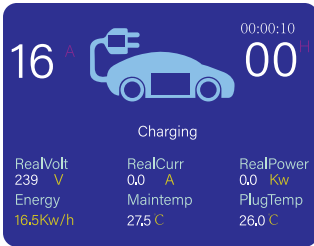

4. Scheduled charging

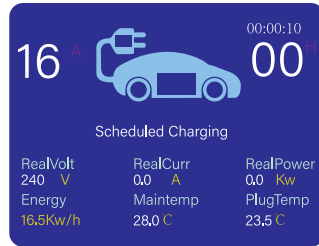

4. Error

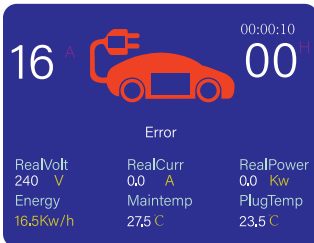

If an error (Error A, Error B... Error H) occurs during charging, first read the possible causes and check the recommended solutions, then contact Qoltec service department.

TROUBLESHOOTING

Error code	Protection function	Solution
Error A	Over-temperature protection	<ol style="list-style-type: none"> 1. Check if the current mode is correct. 2. Disconnect the EV charging plug and the power plug, then try again after the charger has cooled down. If the error still occurs, contact your dealer.
Error B	Short-circuit protection (CP)	<ol style="list-style-type: none"> 1. Disconnect the EV charging plug and the power plug, then reconnect the power plug. 2. If Error - B does not appear on the LCD screen, there is a CP short circuit on the car side. 3. If Error - B still appears on the LCD screen, contact your dealer
Error C	Overvoltage protection	<ol style="list-style-type: none"> 1. Check whether the mains voltage exceeds the recommended voltage. 2. If the voltage at the power plug is too high, wait until the supply voltage returns to normal. 3. If the voltage on the power plug is correct but the charger still displays Error - C, contact your dealer
Error D	Undervoltage protection	<ol style="list-style-type: none"> 1. Check whether the mains voltage is not below the recommended voltage. 2. If the voltage at the power plug is too low, wait until the supply voltage returns to normal. 3. If the voltage on the power plug is correct but the charger still displays Error - D, contact your dealer.
Error F	Short-circuit protection	<ol style="list-style-type: none"> 1. Disconnect the EV charging plug and the power plug, then reconnect the power plug. 2. If Error - F does not appear on the LCD screen, there is a short circuit on the car side. 3. If Error - F still appears on the LCD screen, contact your dealer.
Error G	Leakage protection	<ol style="list-style-type: none"> 1. Disconnect the EV charging plug and the power plug, then reconnect the power plug. 2. If Error - G does not appear on the LCD screen, there is a leakage current on the car side. 3. If Error - G still appears on the LCD screen, contact your dealer.
Error H	Others	Contact your dealer



Producer/Producent:
NTEC sp. z o.o.
ul. Chorzowska 44B,
44-100 Gliwice, Poland

www.b2b.ntec.eu
WEEE/BDO: 000137497
Made in China
Designed in Europe

